

VIVOTEK Fixed Dome Series AM-105 Recessed-mount Bracket

Installation Guide

Corresponding part number: 900026800G

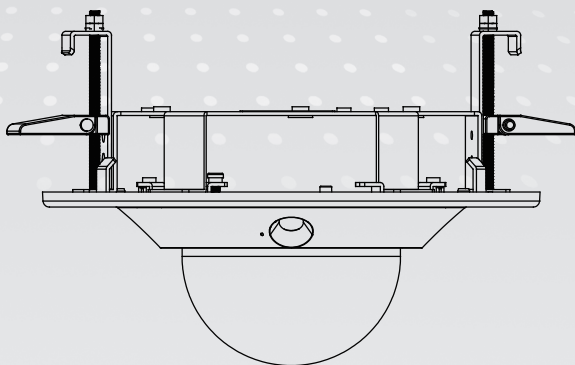

Rev. 1.0

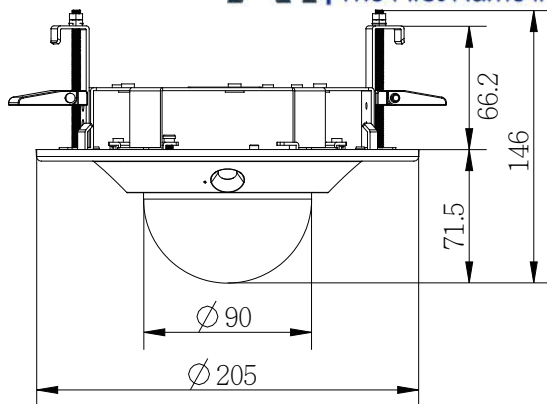

Package Contents

- Recessed-mount bracket
- Screws: 3x round head M4x8L; 3x truss head M3x8L
- 3x adhesive foam washers
- Alignment sticker
- Screwdriver: T10 stardriver

Revision History

- Rev. 1.0: Initial release.



Compatible VIVOTEK Cameras

| | |
|-------------------|-------------------------|
| Fixed Dome series | FD8167, FD8138-H |
|-------------------|-------------------------|

You may also refer to VIVOTEK's website for the list of supported models. Support for other models can be available through time.



IMPORTANT:

Before installing your camera, make sure the built-in PIR (Passive Infrared Sensor) can be directed toward the area of interest, where possible intrusion may occur. (The sensitivity of PIR sensor depends on the object size and temperature differences between the object and the background environment.)

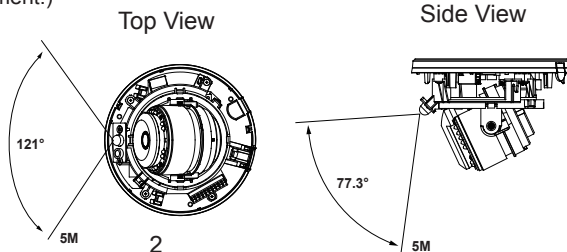

Available from A1 Security Cameras

www.a1securitycameras.com email: sales@a1securitycameras.com



Mounting Hole Definitions

1. Determine a secure location for the recessed-mount bracket.
2. Drill or cut a 190mm hole (in diameter). The maximum thickness of the ceiling/board is 24mm. The ceiling should be able sustain at least a weight of 1.4kg.

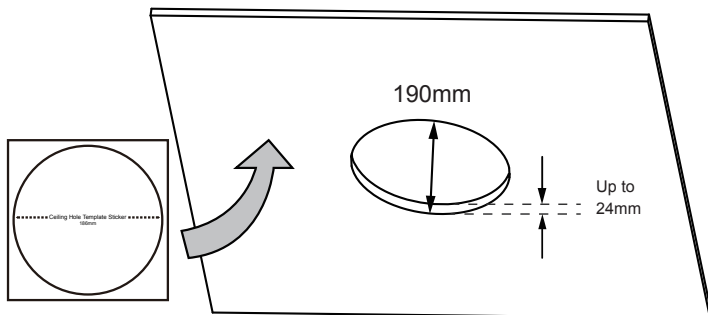

3. Remove dome cover from the camera using the stardriver included in kit.

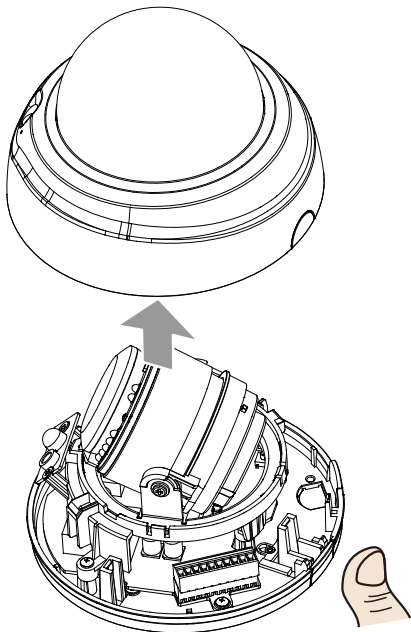

4. Use the included standard 3/8" x 1" screws to secure the camera to the recessed mount bracket.

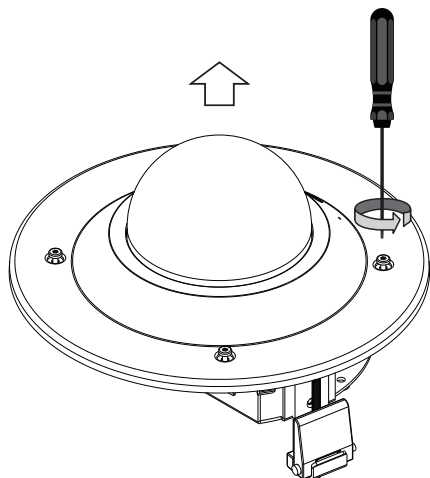

5-1. Install camera to the recessed-mount bracket by driving 3 screws.

5-2. Attach foam washers to the top of screw holes.

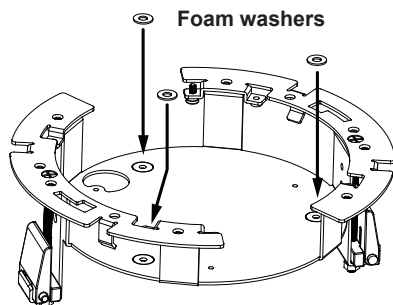

5-3. Install camera to the bracket.

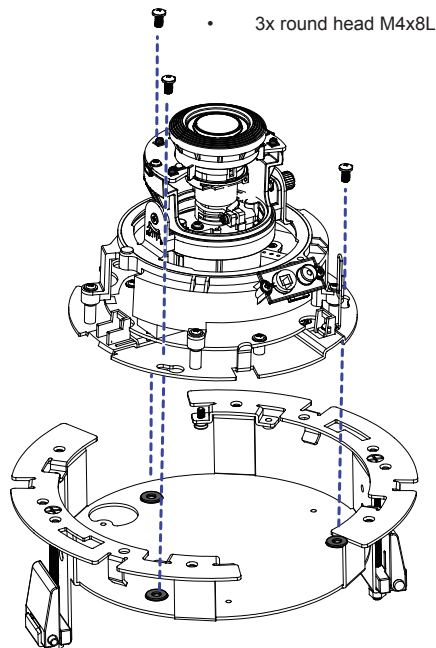

NOTE:

1. Connect and route cables before you secure the recessed-mount bracket to a ceiling.
2. For details on the cable connections with each camera, please refer to their Quick Installation Guide.

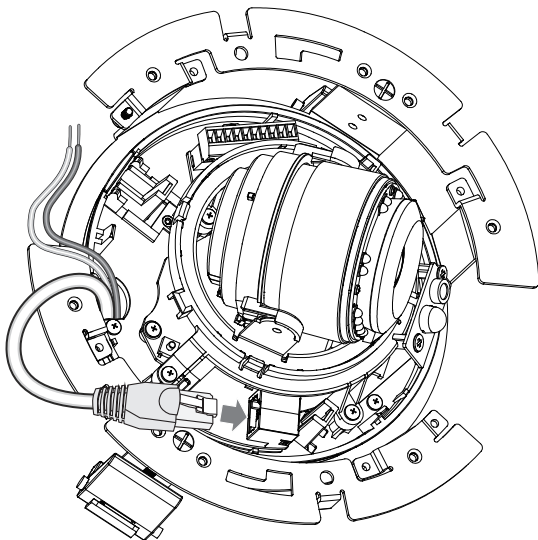

7. Use a #2 Phillips screwdriver to loosen the clamping plates (see drawing below) and insert the recessed-mount bracket through the hole in the ceiling.

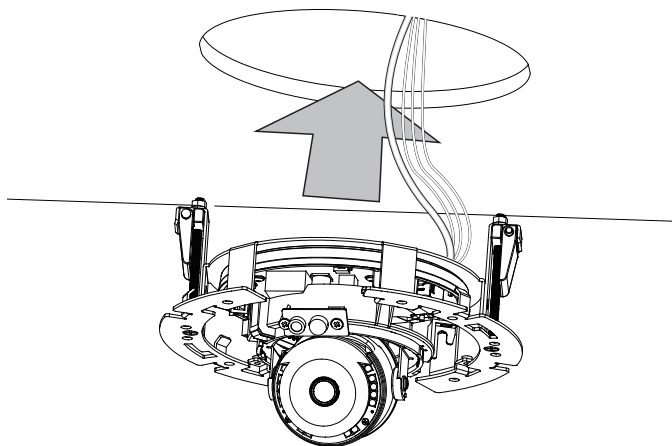

8. Use a #2 Phillips :

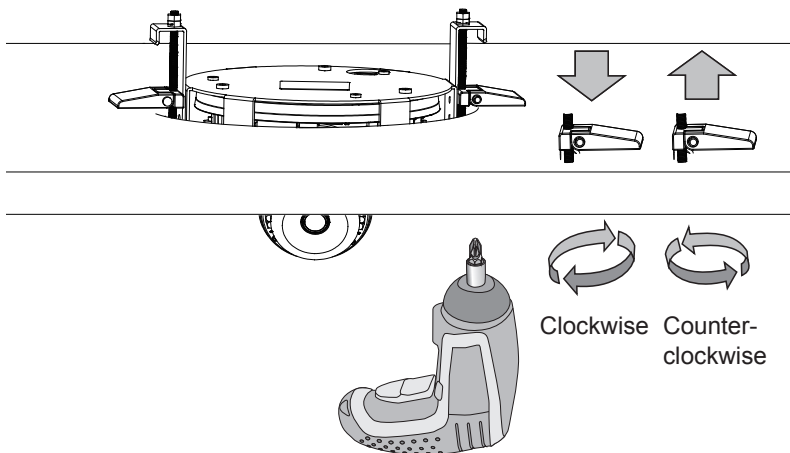

9. Adjust shooting angle and check for a satisfactory image over a web session. When you have a satisfactory live view, tighten the tilt screw, and secure the dome cover from below the ceiling using the T10 stardriver.

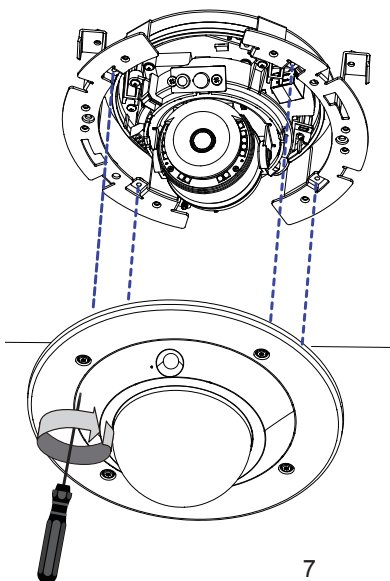

10. You are done with:

