

## Mini Dome Type Network Camera

# Quick Installation Guide

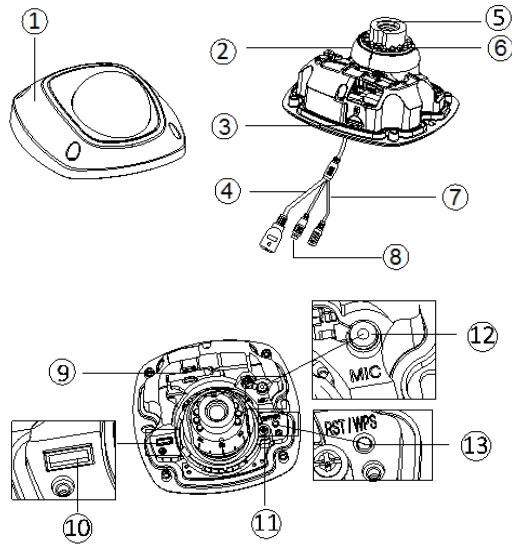

No.	Description	No.	Description
1	Front Cover	8	Audio/Alarm Cables
2	Dome Drive	9	Wi-Fi Antenna
3	Micro SD Card Slot	10	Serial Port Interface
4	Network Cable	11	Hex Screw
5	Lens	12	MIC
6	IR LED	13	RESET/WPS Button
7	Power Cable		

### Note:

Please make sure that the wall is strong enough to withstand three times the weight of the camera.

### Installation Steps:

**1. Drill the screw holes and the cable hole in the ceiling according to the supplied drill template(2 different types).**

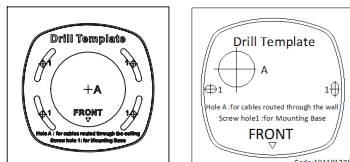

**2. Loosen the set screw on the front cover to disassemble the camera with the supplied Allen key.**

**3. Fix the adapter plate to the ceiling with the supplied expansion screws.**

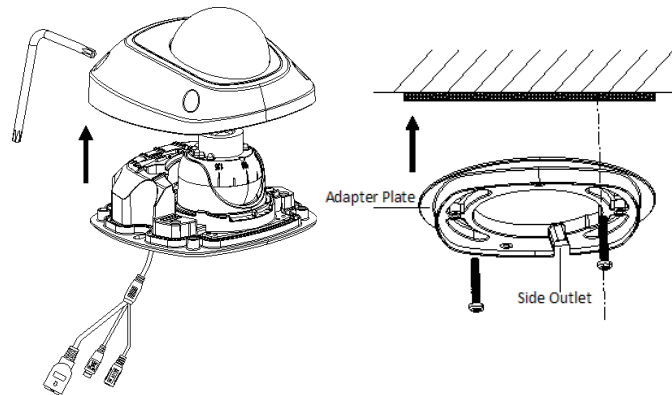

**4. Fix the dome drive with the supplied screws.**

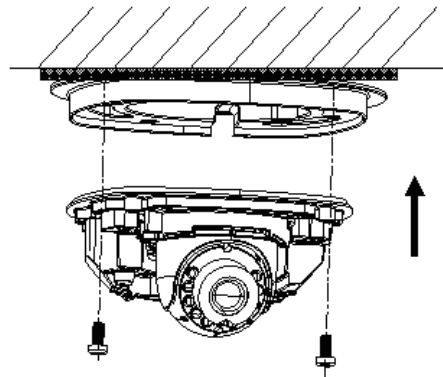

**5. Connect the power cable, network cable, and the audio/alarm cables.**

**6. View the image via the web browser.**

**7. Slightly loosen the hex screw beside the WPS/RESET button to adjust the surveillance angle.**

**8. Use the supplied adjusting tool to adjust the pan [±30°], tilt [0~80°], and rotation direction [0~360°].**

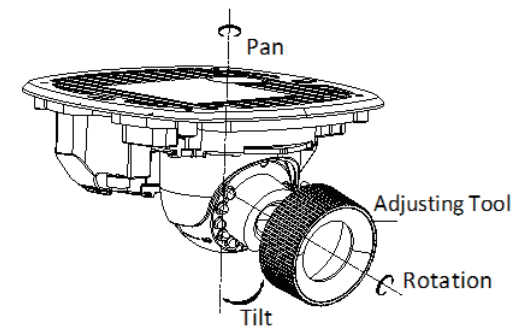

**9. Tighten the hex screw to fix the well-adjusted surveillance angle.**

**10. Align the front cover to the dome drive and tighten the set screws on the front cover.**

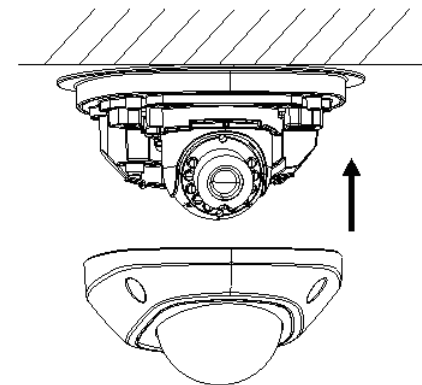

**11. Tear off the protection film softly to complete the installation.**

For detailed instructions of further configuration, please refer to the user manual of network camera.