



DW-VIP4xT2B4

Complete IP Recording Solution

The VMAX IP is sold as part of a complete IP solution, including 4x 2.1MP IP weather resistant bullet cameras. The cameras and NVR are directly and natively integrated to assure a complete compatibility between the cameras and the recorder, for a simple, quick and easy installation and set up.

DW-VIP41T2B4	1TB	DW-VIP44T2B4	4TB
DW-VIP42T2B4	2TB	DW-VIP46T2B4	6TB
DW-VIP43T2B4	3TB	DW-VIP48T2B4	8TB

NVR Summary

The VMAX IP is a simple and hassle-free embedded NVR. Designed around the popular and easy to use VMAX user experience (UX) and with local Power over Ethernet (PoE) support for IP cameras, the VMAX IP is flexible and easy to configure. True HD output for local display and monitoring allows the VMAX IP to support real-time 1080P live viewing and recording of up to 4x IP cameras. The VMAX IP is sold as a complete solution with VMAX IP 2.1MP bullet cameras, making the VMAX IP an elegant and simple solution for single-site small scale applications.

NVR Features

- Support up to 4 2.1MP IP Cameras
- Pivot™ Central Management Software, Up to 128CH
- Mobile Application for iPhone, iPad, iPod, Android Smart Phones and Tablets and Kindle Fire
- MAC Compatible Remote Software
- Intuitive Graphical User Interface (GUI)
- PoE Support to Power IP Cameras Locally
- Bandwidth and Camera Status Monitoring
- Record 30 Frames per Second on Every Channel
- 1 Sensor Input, 1 Relay Output
- Event Notifications via Email, Text and Pivot™ CMS
- Simple & Free DDNS Support for Remote Management

Features cont.

- Easy Web-Based Client with Multi-User Access
- S.M.A.R.T. Health Check with Email Notification
- Help Menu on Major Functions
- Auto & Manual Firmware Upgrade Available
- Import/Export Configuration between Multiple DVRs
- USB Mouse and GUI Control

5 YEAR
 LIMITED WARRANTY

Dimensions (unit : mm)

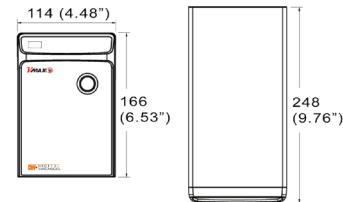

Specifications

VIDEO		
Video Input	Frame Rate	4 IP Channels 1 ~ 30fps
	Resolution	First Stream: 1080P (1920x1080), 720P (1280x720), 640x360 Second Stream: 640x360
Video Output		HD Output
Display Resolution Options		1920x1080p / 1280x720p / 1280x1024 / 1024x768
Screen Display Mode		1, 4, Auto Sequence
Alarm	Sensor Input	1 Input
	Alarm Out	1 Output
Operating System		Embedded Linux
User Interface	Menu Display	Graphical User Interface (GUI)
	Control Methods	USB Mouse
PERFORMANCE		
Recording	Compression	H.264
	Recording Mode	Schedule, Event, Panic, Continuous, Pre & Post Event, Motion, Recording Configuration per Channel
	Pre Recording	3~5 Seconds
	Post Recording	5~15 Seconds
Playback	Recording Rate	First Stream: Maximum 120fps @1080P Second Stream: Maximum 120fps @ 640x360
	Playback Rate	Max 30fps @ 1080P
	Fast Forward Functions	x1/16, x1/8, x1/4, x1/2, x1, x2, x4, x8, x16, x32
	Search Modes	Date & Time, First Data, Last Data, Calendar, Bookmark, System & Event Logs, 1Channel Playback
Storage	HDD Interface	Up to 2 HDD
	Max. Internal HDDs	Up to 8TB (2HDD x 4TB)
	External Storage	USB Flash Drive and HDD
	HDD Interface Type	SATA I / II / III
Features	HDD Health Check	HDD S.M.A.R.T. with E-mail Notifications
	Local PoE Support	4 ports (Built-in, 802.3AF) Power Cameras via the NVR
	Digital Zoom	Yes (Live & Playback)
	Software Upgrade	USB Flash Drive, Network Upgrade, FTP Remote Upgrade
	Remote Client	Mobile App for Apple & Android Smart Phones & Tablets
	Covert Channel	Yes (Live & Playback)
	System Monitoring	Connection Failure, Recording Failure, Fan Failure, Disk Error, Network Traffic Monitoring, Camera Status and Connection Log
Available Models		DW-VIP41T2B4 (1TB Storage) DW-VIP44T2B4 (4TB Storage) DW-VIP42T2B4 (2TB Storage) DW-VIP46T2B4 (6TB Storage) DW-VIP43T2B4 (3TB Storage) DW-VIP48T2B4 (8TB Storage)
NETWORK		
Network Connection		Ethernet (1x 10/100/1000Mbps)
Streaming	Transmission Speed Live	120fps @ 640x360 / 30 fps @ 1080p
	Protocols	TCP/IP, DHCP, NTP, HTTP, DDNS, RTP, RTSP, FTP, SMTP, ONVIF, UPnP
Access	Web Viewer	Live, Playback, & Config, up to 10 multiple connections
	Remote Client	Mobile App for Apple & Android Smart Phones & Tablets
Monitoring Software		Pivot (CMS S/W), ACS Software for MAC OS & Windows
GENERAL		
Operating Temperature / Humidity		0 ~ 40°C (32 ~ 104°F)
Operating Humidity		Less than 90% (Non-Condensing)
Electrical	Power Requirement	Main: 12V DC PoE: 48V DC
	Power Consumption	Main: 36W, 3A PoE: 66W, 1.375A
Dimensions		4.5 x 6.53 x 9.76 in (114 x 166 x 248 mm)
Weight		4.6 lbs (2.08 kg)

*Specifications subject to change without notice.



DWC-BVI2IR



Bullet Camera Summary

The DWC-BVI2IR is a 2.1-megapixel network camera with simple installation and configuration via the VMAX IP NVR on screen display (OSD). The camera is sold as a complete solution with the VMAX IP network video recorder (NVR), offering 3.6mm Fixed Lens, IP66 environmental-rated enclosure, IR LEDs for low light environments and image enhancement features such as WDR and Auto Digital Noise Reduction. Powered and configured completely via the VMAX IP NVR, the VMAX IP bundle is a complete solution that is simple to install and set up, perfect for single-site small scale applications.

Features

- 1/2.8" Sony® Exmor™ CMOS Sensor
- 2.1 Megapixels (1080P, 30fps)
- Complete Camera Control and Configuration via VMAX IP NVR
- Wide Dynamic Range (WDR)
- Simultaneous Dual-Stream
- 3.6mm Fixed Lens
- 50ft IR Range with Intelligent Camera Sync
- True Day/Night with Mechanical IR Cut Filter
- 3D Digital Noise Reduction (3D DNR)
- Power over Ethernet (PoE) & DC12V
- IP66 Certified (Weather Resistant)

Dimensions (unit : mm)

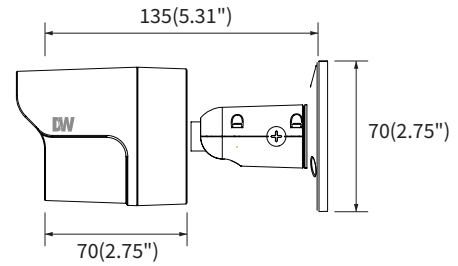

Specifications

IMAGE	
Image Sensor	1/2.8" Sony® Exmor™ CMOS
Total Pixels	1952 (H) x 1116 (V) = 2.18MP
Minimum Scene Illumination	F2.5 (30IRE): 0.15 Lux [Color]
	F2.5 (30IRE): 0.0 Lux [B&W]
S/N Ratio	42dB (AGC Off)
LENS	
Focal Length	3.6mm
Lens Type	Fixed Lens
IR Distance	50ft Range IR
OPERATIONAL	
Exposure Mode	Auto (Shutter, Gain Control)
White Balance	Auto
DNR (Digital Noise Reduction)	Auto (2D / 3D Dual Streaming)
WDR (Wide Dynamic Range)	Off, On
Day and Night	Auto
NETWORK	
LAN	802.3af Compliance 10/100 LAN
Video Compression Type	H.264, MJPEG
Resolution	1080P, 720P, 640 x 360
Frame Rate	Up to 30fps at All Resolutions
Streaming Capability	Dual-Stream at Different Rates and Resolutions
IP	IPv4
Protocol	TCP/IP, UDP, IPv4, RTSP, DHCP
Web Viewer	Camera Configuration and Access via VMAXIP NVR Only
Video Management Software	VMAXIP NVR GUI
ENVIRONMENTAL	
Operating Temperature / Humidity	-10°C ~ 50°C (14°F ~ 122°F)
Operating Humidity	Less than 96% (Non-Condensing)
IP Rating	IP66 (Protects against dust and high pressure water)
Other Certifications	CE, FCC, RoHS
ELECTRICAL	
Power Requirement	DC 12V, PoE (IEEE802.3af Class 2)
Power Consumption	Max 6W, 500mA (LED ON)
MECHANICAL	
Material	Aluminum Die-casting
Dimensions	75 x 70 x 135 mm (2.95 x 2.75 x 5.31 in)
Weight	1.1 lbs (0.5 kg)

*Specifications subject to change without notice.