

# High-Speed Positioning System

[www.boschsecurity.com](http://www.boschsecurity.com)



**BOSCH**

Invented for life



- ▶ Pans up to 100° per second, 360° continuous rotation
- ▶ Tilts up to 40° per second, -90° to +40° range
- ▶ Wide range of camera-zoom combinations
- ▶ Multi-protocol including Biphase and Bilinx
- ▶ IP 66 rated, tough, attractive casing with up to 20 kg balanced load

The Bosch High-Speed Positioning System is a complete solution that is high on quality and performance. It can pan 360° continuously at speeds of up to 100° per second. An extensive range of options lets you tailor the system to your specific requirements.

Autopan and patrol functions are accurate to within 0.02°, with text labels assigned to presets for added convenience. Insert privacy zones or sector blanking to block private areas from being viewed. Automatic lens scaling, which keeps zoom and speed synchronized, ensures smooth video pictures throughout pan and tilt movement.

A completely self-contained unit, the high-speed positioning system is easy to install and maintain. Multi-protocol capabilities, including Bilinx and Biphase, also simplify connections. The tough, protective casing can support 20 kg balanced load and is IP66-rated – ideal for weathering the outdoor conditions common in traffic and industrial applications. All units have a sunshield. Versions with integrated wiper are also available, including an optional washer.

## Functions

### Autopan and patrol

With 0.02° tracking accuracy for preset positioning, autopan and patrol functions are very precise. Assign convenient text labels using up to 20 characters to presets and different areas. Define highly flexible tracking sequences by combining patrol positions with different speed settings, up to a maximum 100° per second pan and 30° per second tilt.

There are four local alarm inputs and two relay outputs.

### Multi-protocol

The high-speed positioning system operates with Bosch hardware platforms – Divar, DiBos, Allegiant – and is fully compatible with control protocols such as Biphase and Bilinx. Biphase allows control of pan, tilt, zoom, focus, and the wiper / washer. Bilinx offers the same functionality as Biphase, with additional communication capability.

### High-speed pan and tilt with automatic scaling

The unit can reach a very fast panning speed of 100° per second with 360° continuous panning in manual mode. Tilt speeds achieve 40° per second in manual

mode. It also offers ample scope for changing the horizontal view, with movement ranging between  $-90^\circ$  below and  $+40^\circ$  above the horizon. To ensure smooth, clear pictures during rapid movement, automatic scaling synchronizes the P&T speed to the amount of zoom.

### Interconnections

- RS-232C connector for firmware upgrades / IP control
- RS-485 connector for control interfaces
- Biphase
- Bilinx

### Certifications and approvals

Safety	acc. to EN 60950 (CE)
Immunity	acc. to EN 50130-4 (CE)
	acc. to EN 55022 Class B (CE)
Emission	acc. to EN 61000-3-2 (CE)
	acc. to EN 61000-3-3 (CE)
Water/dust protection	IP 66 acc. to EN 60529

Region	Certification	
Europe	CE	UPH-Z26H

### Installation/configuration notes

#### UPH dimensions

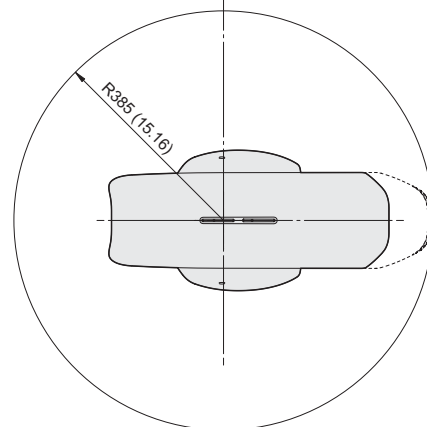
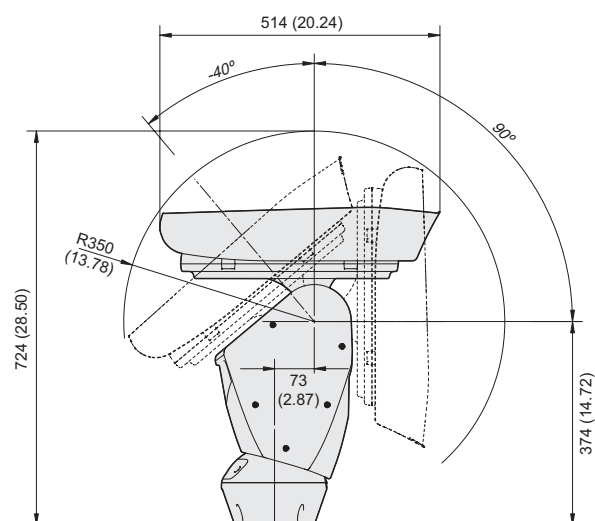
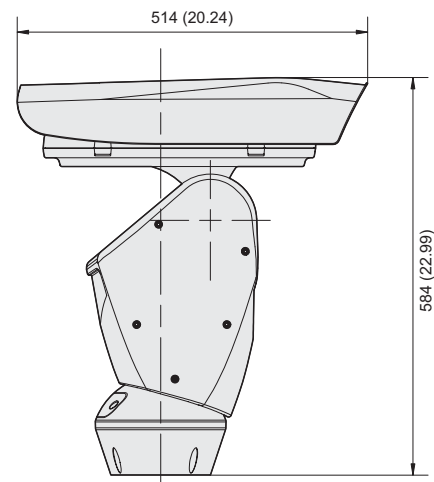
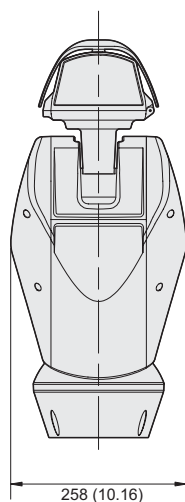

## MTC-WUPH

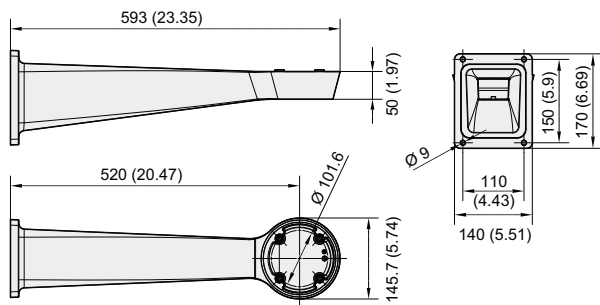

## MTC-PUPH

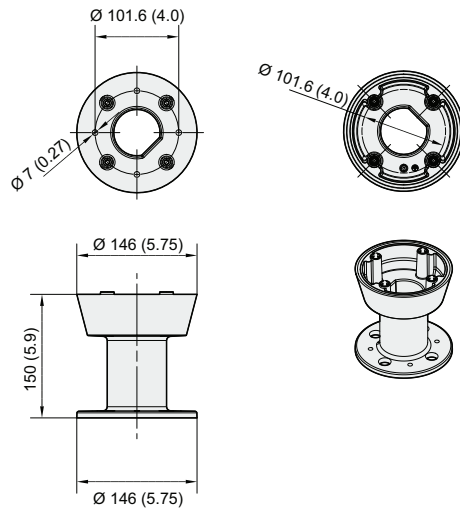

## MTC-CORN-W

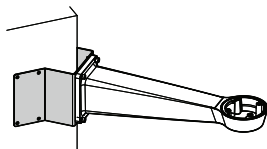

## MTC-POLE-W

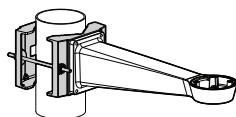

## HAC-WAS05

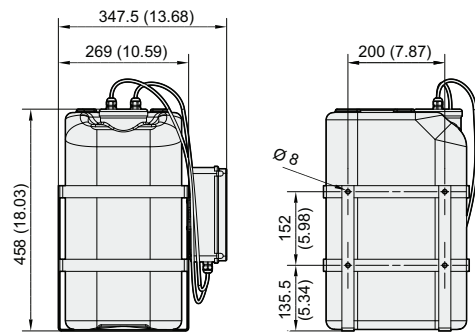

## HAC-WAS30

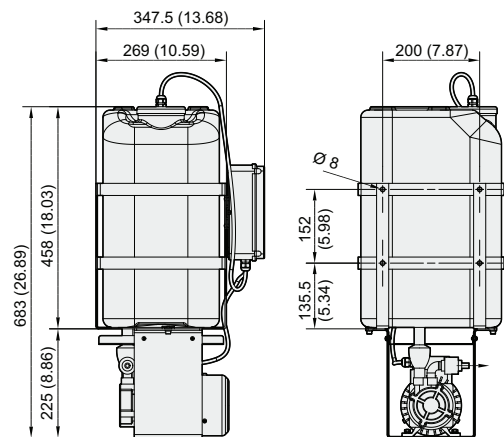

Dimensions in mm (in.)

## Parts included

Quantity	Component
1	Head unit with pre-installed camera and lens
1	Base unit with power supply
1	Serial cable
1	Serial adapter
1	Installation manual
1	Power supply unit
1	Set of mounting accessories
	<ul style="list-style-type: none"> <li>4 mm Allen wrench</li> <li>Bracket with fixing screws</li> <li>Cable ties</li> <li>Tube</li> <li>Label</li> </ul>

**Technical specifications****Electrical**

Input voltage	24 VAC - 5 A / 230 VAC - 0.5 A
Input frequency	50 Hz
Integrated housing	Thermostat heater, 20 W
Camera input	12 VDC - 800 mA
Lens input	+6 to +15 VDC - 200 mA
Wiper (optional) input	24 VAC – 400 mA
Tour control	Autopan; Preset; Patrol
Presets	250 selectable (max. 99 via keyboard)
Preset / area names	20 character string
Preset accuracy	0.02 °
Data set-up	Flash memory
Serial	RS-232, Sub-D for firmware upgrade
Protocols	Bilinx, Biphas and third party protocols on RS485
Supported platforms	DiBos, Divar, Allegiant
Max addressable units	255 (dipswitch setting)
Firmware upgrades	RS-232 interface
Configuration modes	Via PC or OSD
Configuration interface	RS-485

**UPH-Z Series – 36x camera module**

Number of effective pixels	Approx. 440,000
Imager	1/4 in. Exview HAD CCD
Resolution	540 TVL (NTSC, PAL) typical
Minimum illumination	1.4 Lux (typical) at F1.6, 50 IRE
S/N Ratio	More than 50 dB
Electronic shutter	1/1 to 1/10,000 s, 22 steps
White balance	2000 K to 10,000 K
Gain	Off/Auto (with adjustable limit)
AE Control	Auto, manual, priority mode, bright, EV compensation, backlight compensation
Focusing system	Auto (sensitivity: normal, low), One-Push AF, manual, infinity interval AF, zoom trigger AF
Video output	1.0 Vp-p, 75 Ohm
<b>Masking</b>	
Privacy zone	On/off (24 positions)

Max blocks display	8
Blocks resolution	160 H x 120 V

**Lens**

36 x optical zoom	F=3.4 (wide) to 122.4 (tele), F1.6 to F4.5
Digital zoom	12 x (312 x with optical zoom)
Angle of view (H)	57.8° (wide) to 1.7° (tele)

**UPH-Z series – 26x camera module**

Number of effective pixels	Approx. 440,000
Imager	Interline CCD 1/4 –inch format
Resolution	≥ 460 TVL
Minimum illumination	1.0 Lux (typical) at F1.6, 50 IRE
S/N Ratio	More than 50 dB
Electronic shutter	1/1 to 1/10,000 s, 22 steps
White balance	Auto, ATW, indoor, outdoor, One-Push, manual
Gain	Auto/manual (-3 to +28 dB, 2 dB steps)
AE Control	Auto, manual, priority mode, bright, EV compensation, backlight compensation
Focusing system	Auto (sensitivity: normal, low), One-Push AF, manual, infinity interval AF, zoom trigger AF
Video output	CVBS: 1.0 Vpp

**Masking**

Privacy zone	On/off (24 positions)
Max blocks display	8
Blocks resolution	160 H x 120 V

**Lens**

26 x optical zoom	F=3.5 (wide) to 91.0 mm (tele), F1.6 to F3.8
Digital zoom	12 x (312 x with optical zoom)
Angle of view (H)	55° (wide) to 2.3° (tele)

**Mechanical**

Dimensions (H x W x D)	584 x 258 x 514 mm (23 x 10.2 x 20.2 in)
Weight	Approx. 14 kg (31 lb)
Mounting	Top mount (OTT)
Color	Light grey (RAL 7035)
Material	Die cast and extruded aluminum, ABS
Rotation	

horizontal	360° continuous	
vertical	-90° to +40°	
Speed	Manual	Patrol / Autopan
horizontal (pan)	0.1° to 100°/s	0.1° - 100°/s
vertical (tilt)	0.1° to 40°/s	0.1° - 30°/s
Static / dynamic torque		
horizontal	20 Nm	
vertical	20 Nm	
Transmission	Toothed belt	

### Environmental

Operating temperature	-20 °C to +50 °C (-4 °F to +122 °F)
Storage temperature	-20 °C to +60 °C (-4 °F to +140 °F)
Humidity	<90% relative humidity (noncondensing)
Enclosure protection	IP 66

### Ordering information

#### UPH-Z26H-10 HS P&T with 26x D/N Camera Module

24 VAC 50/60 Hz, Biphase and Bilinx, 26x zoom AF, PAL

Order number **UPH-Z26H-10**

#### UPH-Z26HW-10 HS P&T + wiper with 26x D/N Camera Module

24 VAC 50/60 Hz, Biphase and Bilinx, 26x zoom AF, PAL

Order number **UPH-Z26HW-10**

#### UPH-Z26H-50 HS P&T with 26x D/N Camera Module

230 VAC 50 Hz, Biphase and Bilinx, 26x zoom AF, PAL

Order number **UPH-Z26H-50**

#### UPH-Z26HW-50 HS P&T + wiper with 26x D/N Camera Module

230 VAC 50 Hz, Biphase and Bilinx, 26x zoom AF, PAL

Order number **UPH-Z26HW-50**

#### UPH-2D10-10 HS P&T with 1/2" DinionXF D/N Camera

24 VAC, 10x zoom, IR, 8.5 – 85 mm, PAL

Order number **UPH-2D10-10**

#### UPH-2D10W-10 HS P&T + wiper with 1/2" DinionXF D/N Camera

24 VAC, 10x zoom, IR, 8.5 – 85 mm, PAL

Order number **UPH-2D10W-10**

#### UPH-2D10-50 HS P&T with 1/2" DinionXF D/N Camera

230 VAC, 10x zoom, IR, 8.5 – 85 mm, PAL

Order number **UPH-2D10-50**

#### UPH-2D10W-50 HS P&T + wiper with 1/2" DinionXF D/N Camera

230 VAC, 10x zoom, IR, 8.5 – 85 mm, PAL

Order number **UPH-2D10W-50**

#### UPH-2D15-10 HS P&T with 1/2" DinionXF Camera

24 VAC, 15x zoom, 8 – 120 mm, PAL

Order number **UPH-2D15-10**

#### UPH-2D15W-10 HS P&T + wiper with 1/2" DinionXF Camera

24 AC, 15x zoom, 8 – 120 mm, PAL

Order number **UPH-2D15W-10**

#### UPH-2D15-50 HS P&T with 1/2" DinionXF Camera

230 VAC, 15x zoom, 8 – 120 mm, PAL

Order number **UPH-2D15-50**

#### UPH-2D15W-50 HS P&T + wiper with 1/2" DinionXF Camera

230 VAC, 15x zoom, 8 – 120 mm, PAL

Order number **UPH-2D15W-50**

#### UPH-3D10-10 HS P&T with 1/3" DinionXF D/N Camera

24 VAC, 10x zoom, IR, 8.5 – 85 mm, PAL

Order number **UPH-3D10-10**

#### UPH-3D10W-10 HS P&T + wiper with 1/3" DinionXF D/N Camera

24 VAC, 10x zoom, IR, 8.5 – 85 mm, PAL

Order number **UPH-3D10W-10**

#### UPH-3D10-50 HS P&T with 1/3" DinionXF D/N Camera

230 VAC, 10x zoom, IR, 8.5 – 85 mm, PAL

Order number **UPH-3D10-50**

#### UPH-3D10W-50 HS P&T + wiper with 1/3" DinionXF D/N Camera

230 VAC, 10x zoom, IR, 8.5 – 85 mm, PAL

Order number **UPH-3D10W-50**

#### UPH-3D15-10 HS P&T with 1/3" DinionXF Camera

24 VAC, 15x zoom, 8 – 120 mm, PAL

Order number **UPH-3D15-10**

#### UPH-3D15W-10 HS P&T + wiper with 1/3" DinionXF Camera

24 VAC, 15x zoom, 8 – 120 mm, PAL

Order number **UPH-3D15W-10**

#### UPH-3D15-50 HS P&T with 1/3" DinionXF Camera

230 VAC, 15x zoom, 8 – 120 mm, PAL

Order number **UPH-3D15-50**

#### UPH-3D15W-50 HS P&T + wiper with 1/3" DinionXF Camera

230 VAC, 15x zoom, 8 – 120 mm, PAL

Order number **UPH-3D15W-50**

### Accessories

#### MTC-WUPH Outdoor Wall Mount

for UPH series

Order number **MTC-WUPH**

#### MTC-PUPH Outdoor Pole Mount

for mounting a UPH series unit to the top of a pole

Order number **MTC-PUPH**

**MTC-CORN-W Corner Adapter for MTC-WUPH**

Order number **MTC-CORN-W**

---

**MTC-POLE-W Pole Adapter for MTC-WUPH**

for mounting a UPH series unit to the side of a pole

Order number **MTC-POLE-W**

---

**Represented by:**

**Americas:**

Bosch Security Systems, Inc.  
130 Perinton Parkway  
Fairport, New York, 14450, USA  
Phone: +1 800 289 0096  
Fax: +1 585 223 9180  
security.sales@us.bosch.com  
www.boschsecurity.us

**Europe, Middle East, Africa:**

Bosch Security Systems B.V.  
P.O. Box 80002  
5617 BA Eindhoven, The Netherlands  
Phone: + 31 40 2577 284  
Fax: +31 40 2577 330  
emea.securitysystems@bosch.com  
www.boschsecurity.com

**Asia-Pacific:**

Robert Bosch (SEA) Pte Ltd, Security  
Systems  
11 Bishan Street 21  
Singapore 573943  
Phone: +65 6571 2808  
Fax: +65 6571 2699  
apr.securitysystems@bosch.com  
www.boschsecurity.asia

**China:**

Bosch (Shanghai) Security Systems Ltd.  
201 Building, No. 333 Fuquan Road  
North IBP  
Changning District, Shanghai  
200335 China  
Phone +86 21 22181111  
Fax: +86 21 22182398  
www.boschsecurity.com.cn

**America Latina:**

Robert Bosch Ltda Security Systems Division  
Via Anhanguera, Km 98  
CEP 13065-900  
Campinas, Sao Paulo, Brazil  
Phone: +55 19 2103 2860  
Fax: +55 19 2103 2862  
latam.boschsecurity@bosch.com  
www.boschsecurity.com