



Package Contents



Camera



Mounting Bracket



Ceiling Backing Plate



Flat Head Screws (Qty. 4)



Keps Nuts (Qty. 4)



Screws (Qty. 4)



Screw Anchors (Qty. 4)

Installation Requirements

- Phillips screwdriver
- Drill and drill bit (6 mm for wall-mounting or 3 mm for ceiling-mounting)
- Cat5/6 cable for indoor installations

Outdoor Installation Requirements



Important: The UVC G3 Dome may be installed outdoors under an eave or other protected location. Do not install the UVC G3 Dome in an open



UVC-G3-DOME Quick Start Guide

- Mounting location should be at least 60 cm (2 ft) from the edge of the eave or ceiling.
- Cable feed must be pointed downwards when wall-mounted.
- Shielded Category 5 (or above) cabling with drain wire should be used for all outdoor wired Ethernet connections and should be grounded through the AC ground of the PoE.

We recommend that you protect your networks from harmful outdoor environments and destructive ESD events with industrial-grade, shielded Ethernet cable from Ubiquiti. For more details, visit ui.com/toughcable

- Surge protection should be used for all outdoor installations. We recommend that you use two Ethernet Surge Protectors, model ETH-SP-G2, one near the UVC G3 Dome and the other at the entry point to the building. The ETH-SP-G2 will absorb power surges and safely discharge them into the ground.

Hardware Overview





UVC-G3-DOME Quick Start Guide



1 Cable Gland

For outdoor installations, ensure the rubber Cable Gland is installed for added protection.

2 Security Slot

When removing the G3 Dome Camera from the Mounting Bracket, insert a paper clip in the Security Slot to release the Lock Tab and turn the G3 Camera counterclockwise.

3 LED

The LED will light steady blue during bootup. After bootup, the LED will flash until the camera is adopted by the NVR. Upon adoption the LED will light steady blue for 10 minutes and then turn off.



The Ethernet port is a 10/100 Ethernet port used to connect the power and should be connected to the LAN and DHCP server.

5 Reset Button

To reset the camera to factory defaults, press and hold the Reset button for more than 10 seconds while the camera is powered on.

6 microSD Slot

Reserved for future use.

Hardware Installation

Wall Mount

1.

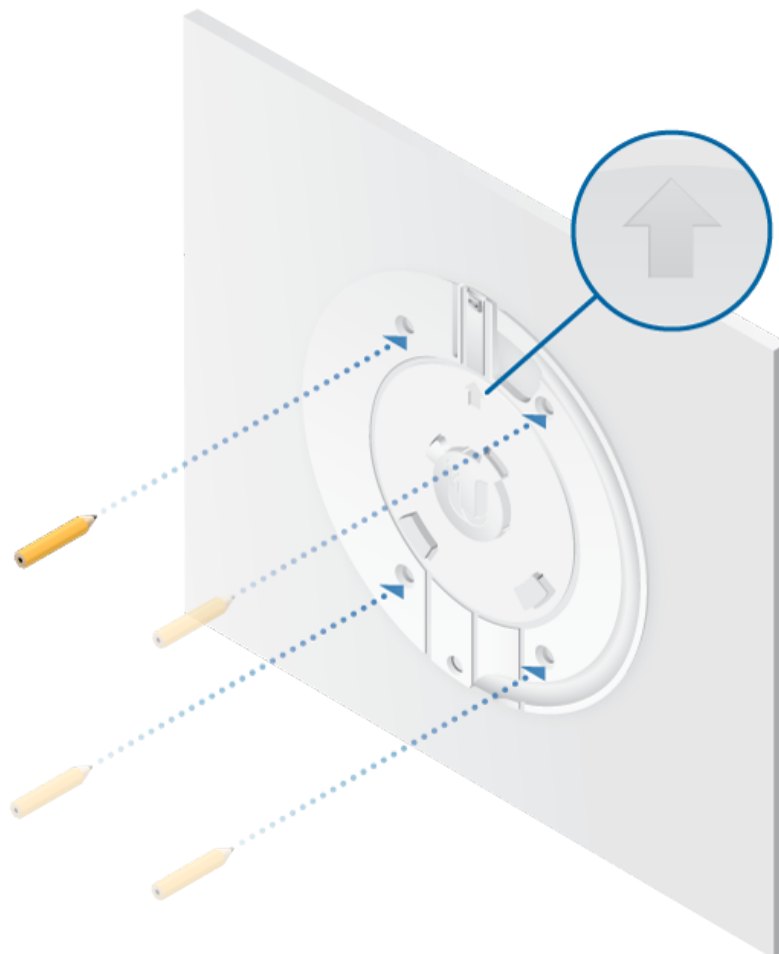

2.



UVC-G3-DOME Quick Start Guide



Optional

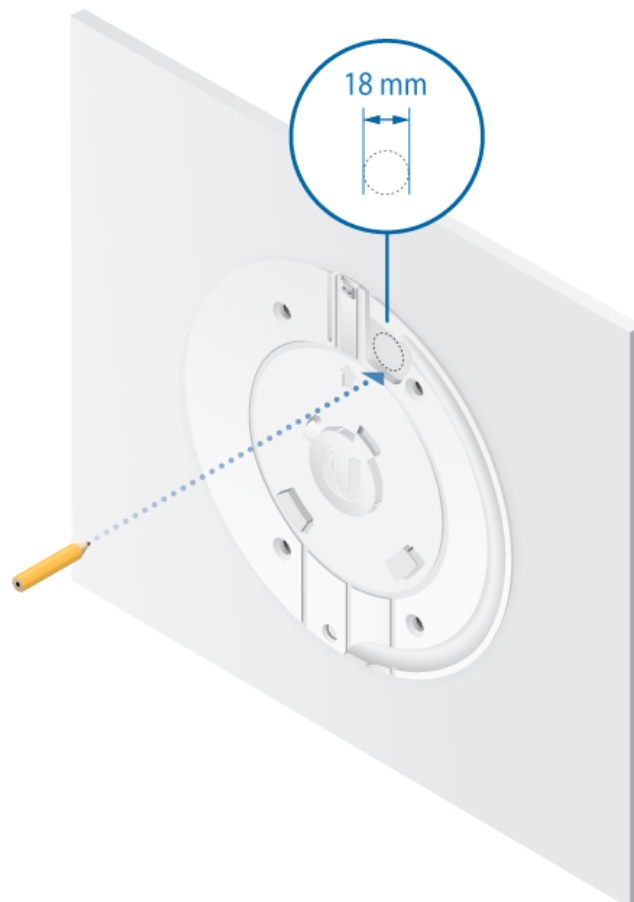



UVC-G3-DOME Quick Start Guide



3.

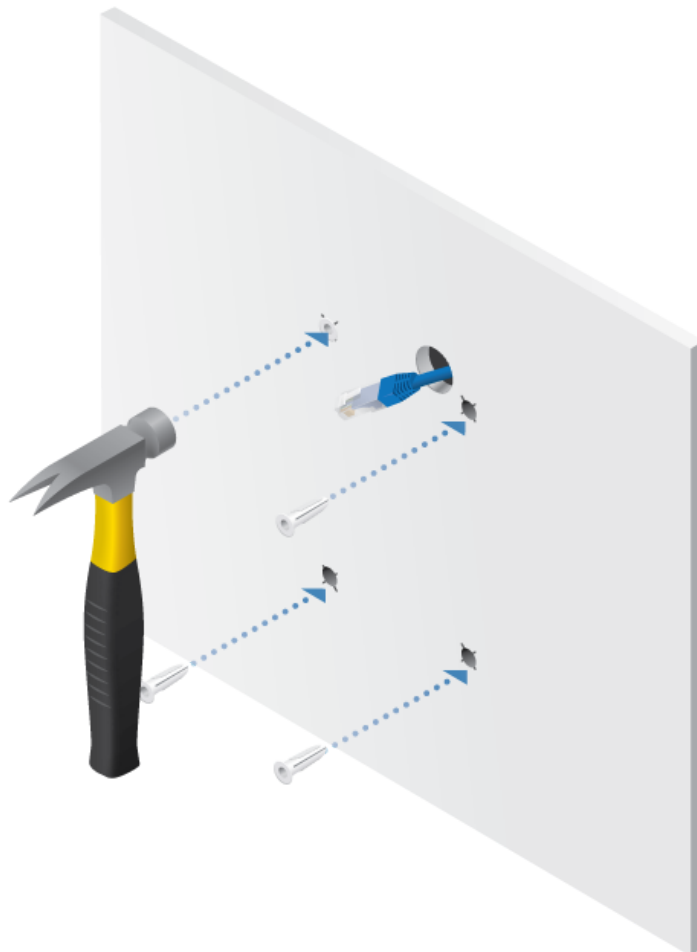

4.



UVC-G3-DOME Quick Start Guide

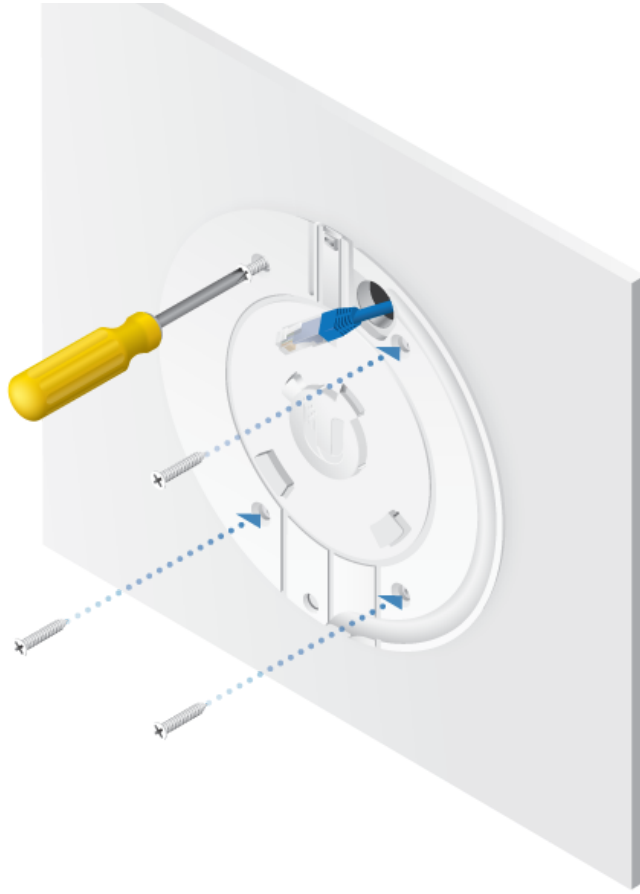

5.

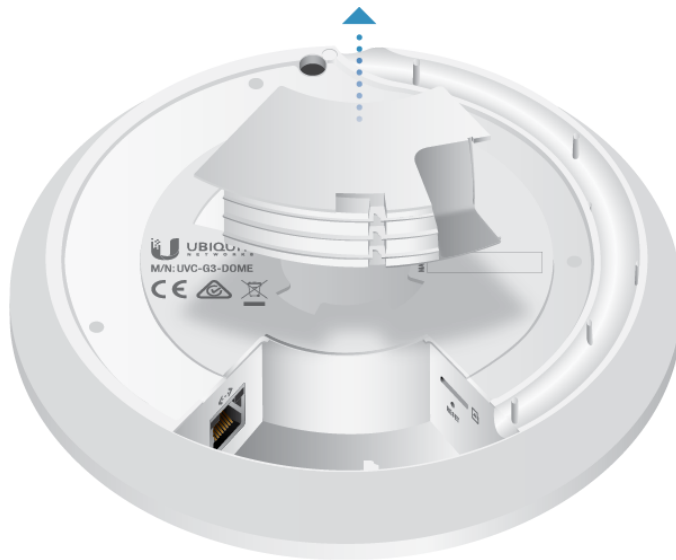

6.



UVC-G3-DOME Quick Start Guide

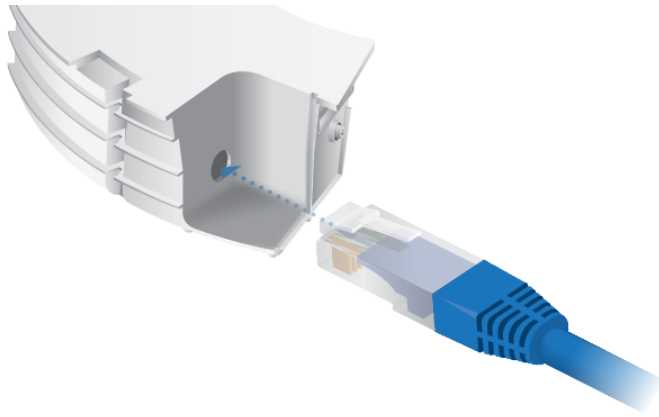

7.



8.



Optional

UVC-G3-DOME Quick Start Guide



9.

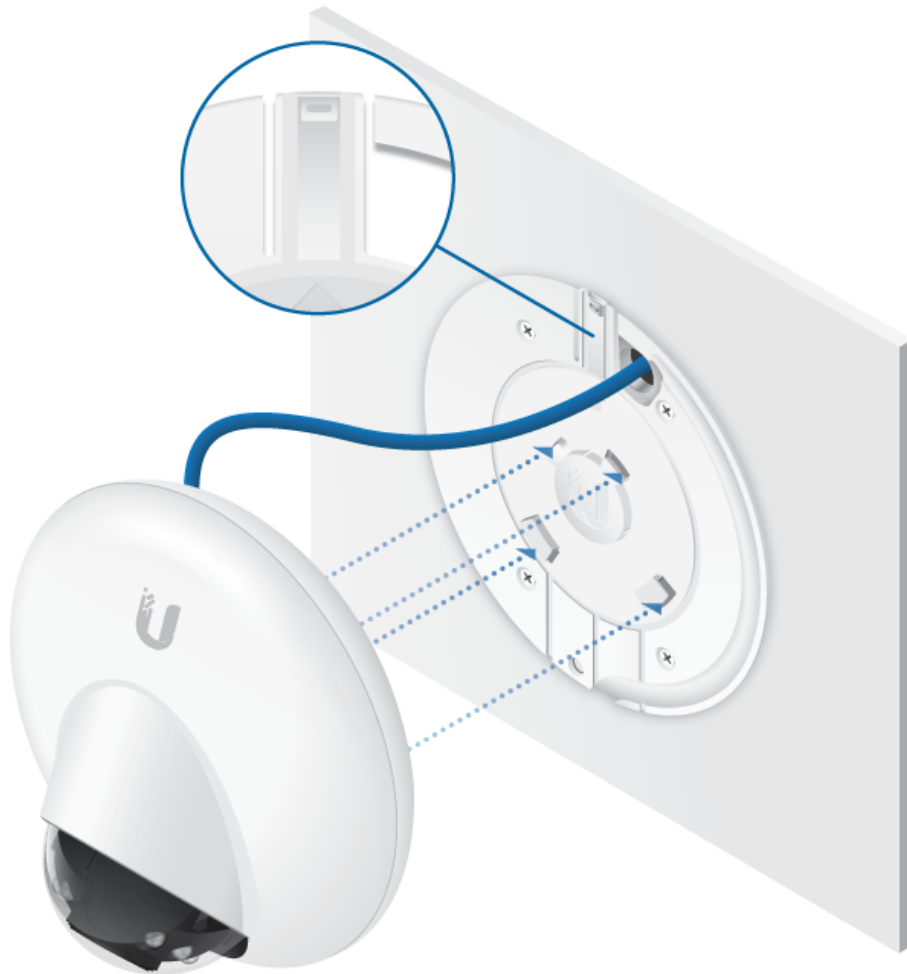

10.



Ceiling Mount

1.



UVC-G3-DOME Quick Start Guide

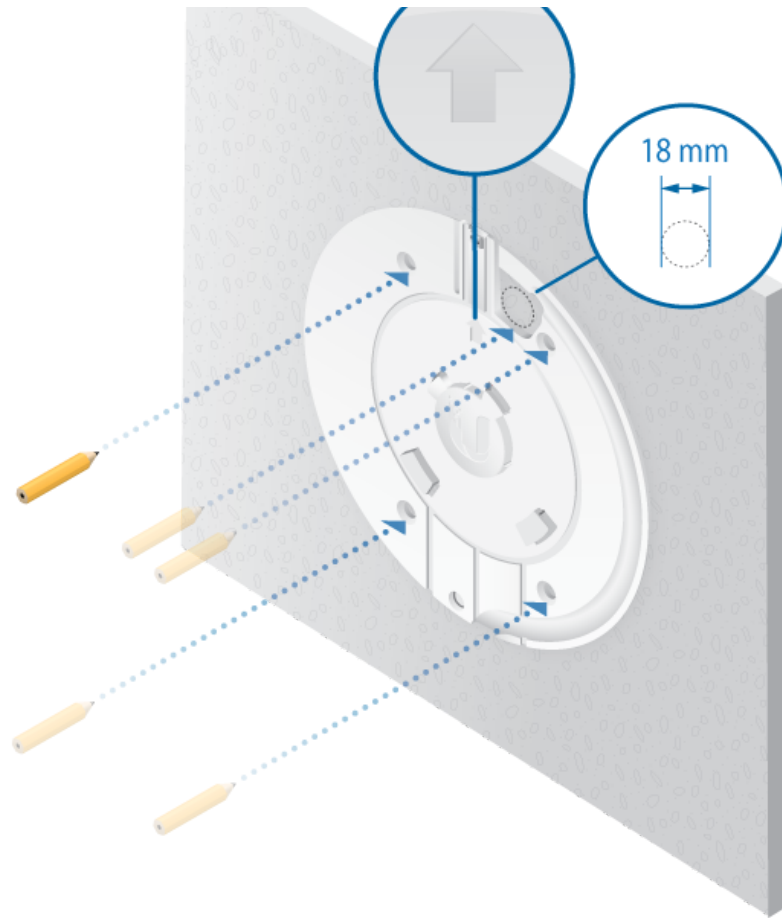

2.

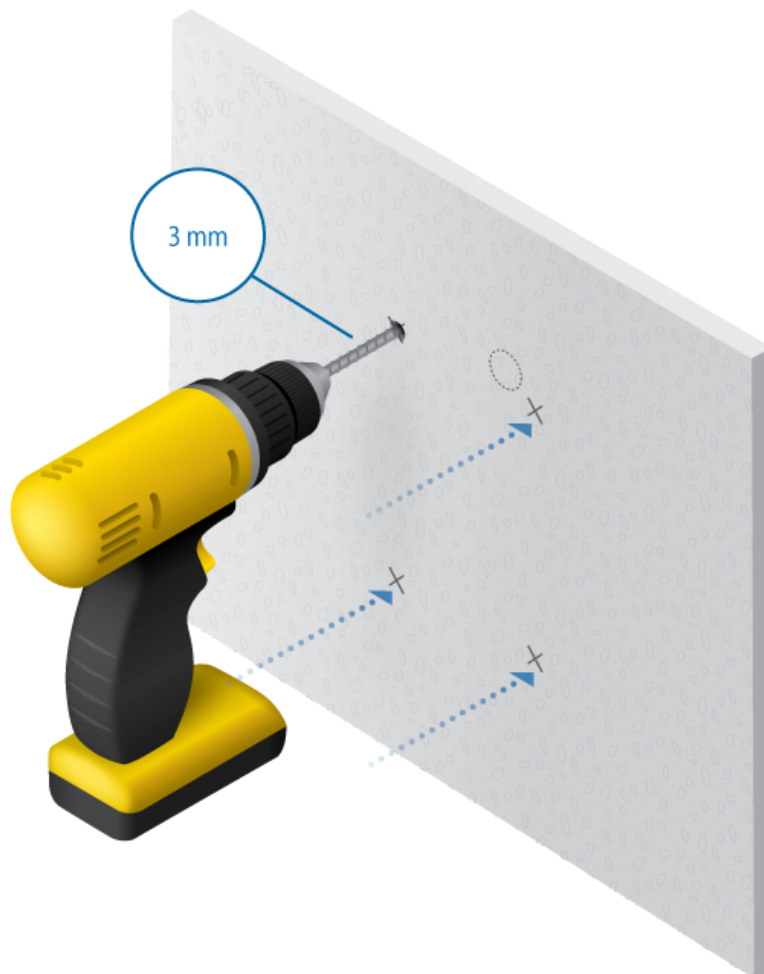

3.



UVC-G3-DOME Quick Start Guide



4.



UVC-G3-DOME Quick Start Guide

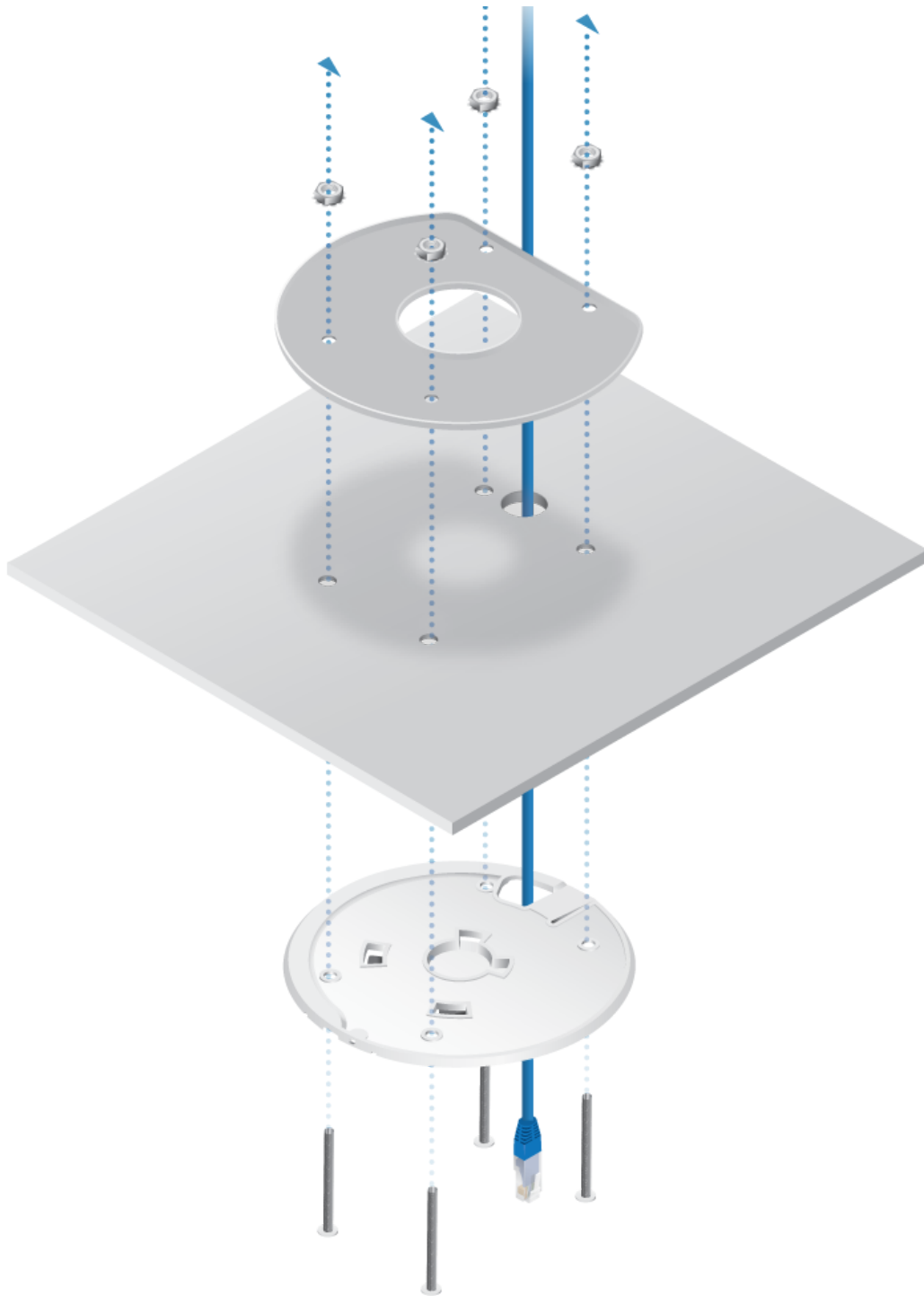

5.



UVC-G3-DOME Quick Start Guide

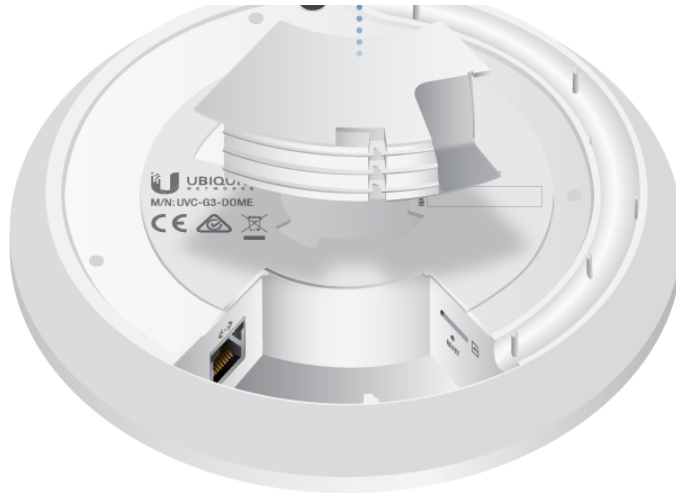

6.

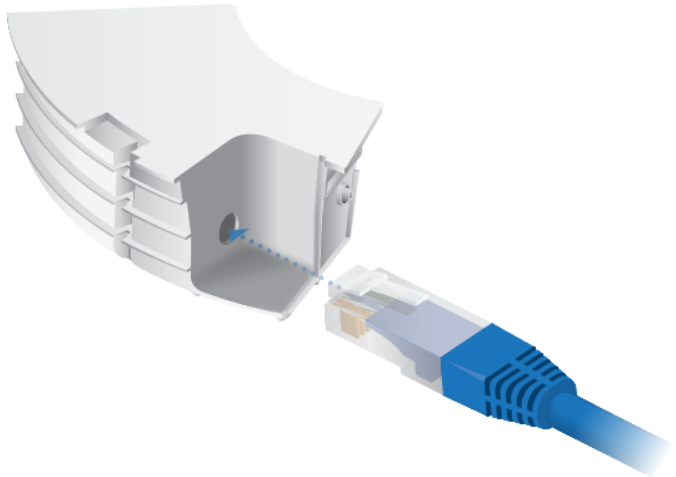

7.



8.



UVC-G3-DOME Quick Start Guide

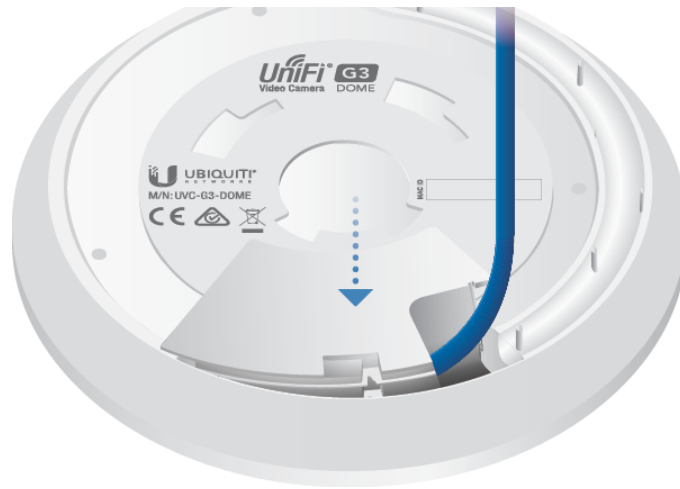

9.



10.



UVC-G3-DOME Quick Start Guide



Adjusting the Camera Angle

1.



2.

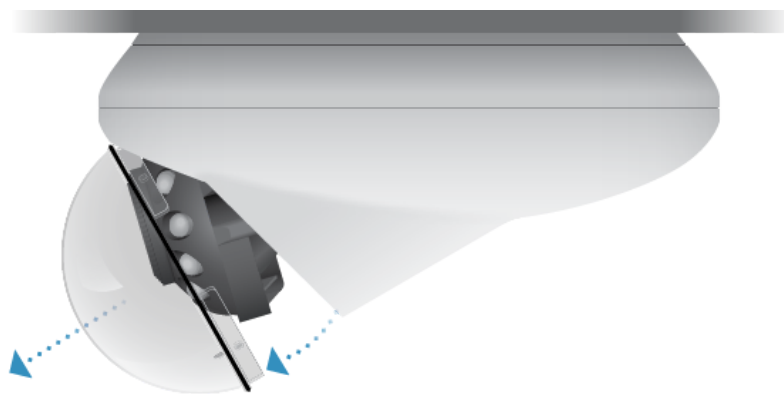

3.



UVC-G3-DOME Quick Start Guide

4.

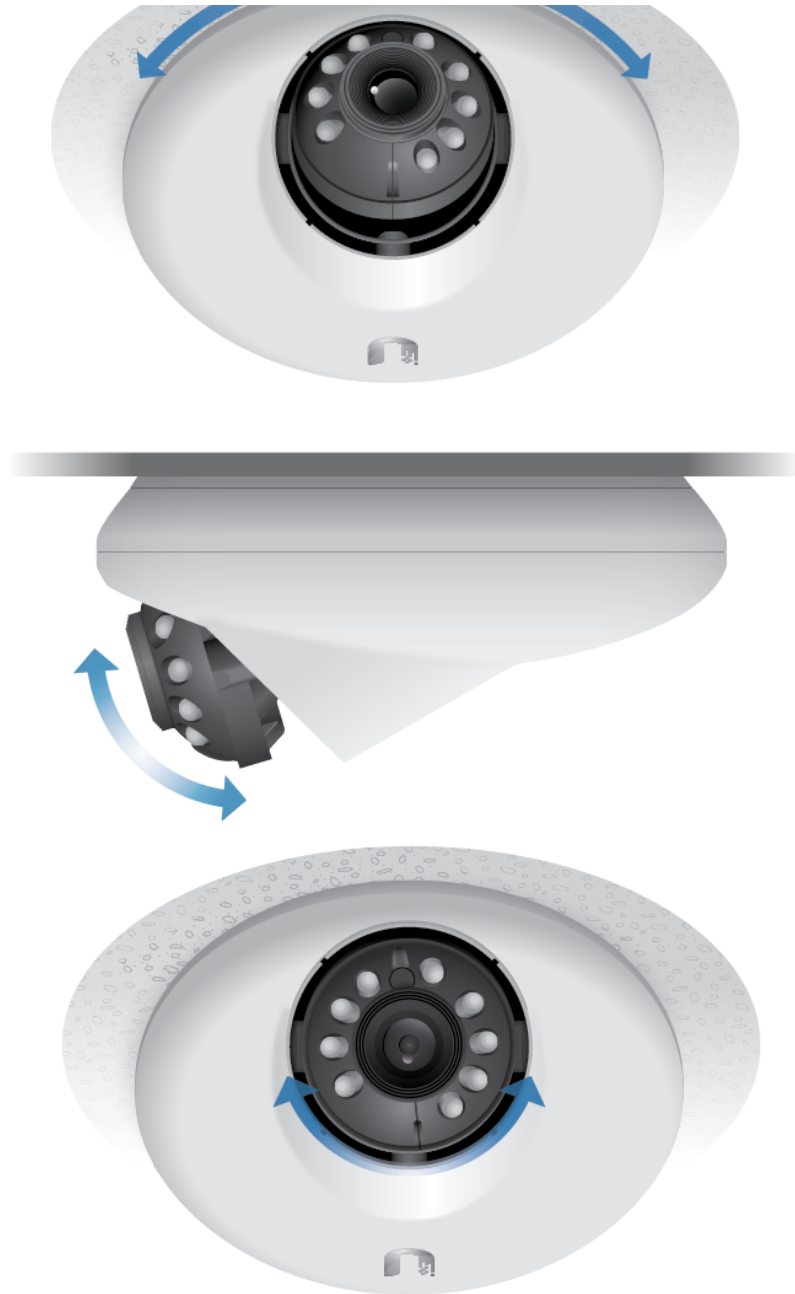

5.



6.



Connecting Power

The G3 DOME features auto-sensing 802.3af PoE and can be powered by any of the following:

- Ubiquiti UniFi Switch
- 802.3af PoE compliant switch
- Ubiquiti PoE Adapter (24V, 0.5A, not included)

Connecting to a PoE Switch

Connect the Ethernet cable from the G3 Dome Camera directly to a PoE port on the switch.



UVC-G3-DOME Quick Start Guide



Setting Up UniFi Protect via App



Launch the UniFi Protect Mobile App and follow the on-screen instructions to complete setup.

Specifications

UVC-G3-DOME	
Dimensions	Ø 132 x 60 mm (Ø 5.20 x 2.36")



UVC-G3-DOME Quick Start Guide

Weight	260 g (9.1 / oz)
Sensor	1/3" 4-Megapixel HDR Sensor
Lens	EFL 2.8 mm / F2.0
Viewing Angle	
Before Lens Correction	100.4° (H), 59.1° (V), 117.3° (D)
After Lens Correction	87.8° (H), 55.4° (V), 96.4° (D)
Night Mode	IR LEDs with Mechanical ICR Filter
Video Compression	H.264
Resolution	1080p FHD (1920 x 1080)
Maximum Frame Rate	30 FPS
Image Settings	Brightness, Contrast, Sharpness, Saturation, Noise Reduction, 50/60 Hz
Microphone	Yes
Management Interface	UniFi Protect
Networking Interface	(1) 10/100 Ethernet Port
Max. Power Consumption	4W
Power Method	802.3af PoE / 24V Passive PoE
Power Supply	802.3af PoE Switch
Supported Voltage	24V to 48V
Mounting	Wall/Ceiling Mount
Operating Temperature	-30 to 50° C (-22 to 122° F)
Operating Humidity	20 to 90% Noncondensing

Safety Notices

1. Read, follow, and keep these instructions.
2. Heed all warnings.
3. Only use attachments/accessories specified by the manufacturer.



WARNING: Hot surface. Do not touch.



WARNING: Do not use this product in location that can be submerged by water.



WARNING: Avoid using this product during an electrical storm. There may be a remote risk of electric shock from lightning.



UVC-G3-DOME Quick Start Guide

1. Compliance is required with respect to voltage, frequency, and current requirements indicated on the manufacturer's label. Connection to a different power source than those specified may result in improper operation, damage to the equipment or pose a fire hazard if the limitations are not followed.
2. There are no operator serviceable parts inside this equipment. Service should be provided only by a qualified service technician.

Limited Warranty

ui.com/support/warranty

The limited warranty requires the use of arbitration to resolve disputes on an individual basis, and, where applicable, specify arbitration instead of jury trials or class actions.

Compliance

FCC

Changes or modifications not expressly approved by the party responsible for compliance could void the user's authority to operate the equipment.

This device complies with Part 15 of the FCC Rules. Operation is subject to the following two conditions.

1. This device may not cause harmful interference, and
2. This device must accept any interference received, including interference that may cause undesired operation.

This equipment has been tested and found to comply with the limits for a Class A digital device, pursuant to Part 15 of the FCC Rules. These limits are designed to provide reasonable protection against harmful interference when the equipment is operated in a commercial environment. This equipment generates, uses, and can radiate radio frequency energy and, if not installed and used in accordance with the instruction manual, may cause harmful interference to radio communications. Operations of this equipment in a residential area is likely to cause harmful interference in which case the user will be required to correct the interference at his own expense.

ISED Canada

CAN ICES-3(A)/NMB-3(A)

Australia and New Zealand



Warning: This equipment is compliant with Class A of CISPR 32. In a residential environment this equipment may cause radio interference.

CE Marking

CE marking on this product represents the product is in compliance with all directives that are applicable to it.





Declaration of Conformity

Online Resources

