



# Unmanaged PoE Switch

AW-FET-060P-060 / AW-FGT-100P-110  
AW-FGT-180P-250 / AW-FGT-260P-370



VIVOTEK Unmanaged PoE Switches are purpose-built for surveillance, ensuring stable and secure data transmission with VLAN and Video QoS. Adaptive Extended Mode detects cable length and automatically adjusts the data rate, supporting transmission up to 250m per port. This provides the flexibility required for large-scale deployments. This series meets the demands of expansive surveillance systems with ease and reliability.

## Features

● Hardware

<b>Adaptive Extended PoE Up to 250m</b> With automatic cable detection and speed adjustment	<b>Power Over Ethernet up to 30W</b>
<b>PD Alive</b> Automatically restarts idle devices by repowering	<b>Video QoS</b> Optimized for network cameras video quality
<b>VLAN Segmentation</b> Isolate devices and optimize bandwidth	<b>6KV Surge Protection</b>

## Surveillance-Ready

### Optimized Video Performance

Video QoS ensures reliable video transmission, prioritizing data flow and quality for seamless monitoring with network cameras. Whether for real-time viewing or recording, this feature guarantees uninterrupted performance even in high-traffic networks.

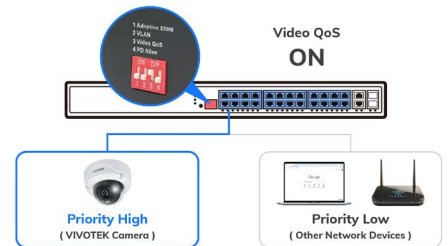

### Smart Device Recovery

Powered Device Alive (PD Alive) detects idle devices and reboots power automatically. This proactive recovery minimizes downtime, enhances system reliability, and ensures your critical surveillance infrastructure remains operational without manual intervention.

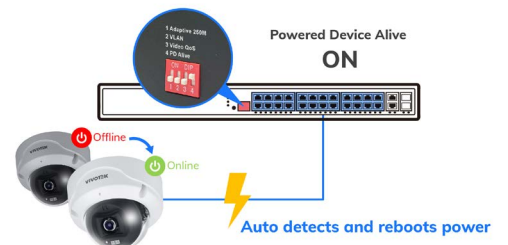

# Enhanced Connectivity

## Flexible Deployment for Long Distances

VIVOTEK Unmanaged PoE Switches are built to adapt to diverse deployment needs. With Adaptive Extended Mode, these switches automatically detect cable length and adjust transmission speeds to 100Mbps or 10Mbps. This makes them ideal for large-scale environments such as campuses, warehouses, outdoor facilities, and other expansive surveillance deployments.

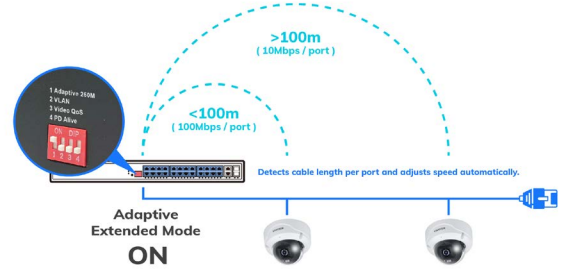

## Fiber-Ready Networking

With compatibility for fiber optic environments via SFP uplink ports and SFP transceivers, these switches offer seamless integration with long-distance, high-speed backbone connections. This flexibility allows network architects to scale systems effortlessly while maintaining robust connectivity across expansive areas.



## Ordering Information

Model	AW-FET-060P-060	AW-FGT-100P-110	AW-FGT-180P-250	AW-FGT-260P-370
PoE Ports	4	8	16	24
Uplink Ports	2xFE RJ45	2xGbE Combo	2xGbE Combo	2xGbE Combo
PoE Power Budget	60W	110W	250W	370W
Max. Power Consumption	65W	120W	260W	380W
Switching Bandwidth	1.2 Gbps	5.6 Gbps	7.2 Gbps	8.8 Gbps
Forwarding Rate	0.8928 Mpps	4.1664 Mpps	5.3568 Mpps	6.5472 Mpps

## Accessory

### SFP Transceiver



**SFP-1000-MM85-X5**  
1.25G,MMF, 0.5km



**SFP-1000-MM13-02**  
1.25G,MMF, 2km



**SFP-1000-MM13-10**  
1.25G,SMF, 10km



**SFP-1000-SM13-40**  
1.25G,SMF, 40km